

Prairie Kraft Specialties, LLC



2024 Cabin Catalog



Port Huron, MI KOA

One-Room KOA Cabin

PREASSEMBLED

12' W x 12' L plus 6' Porch

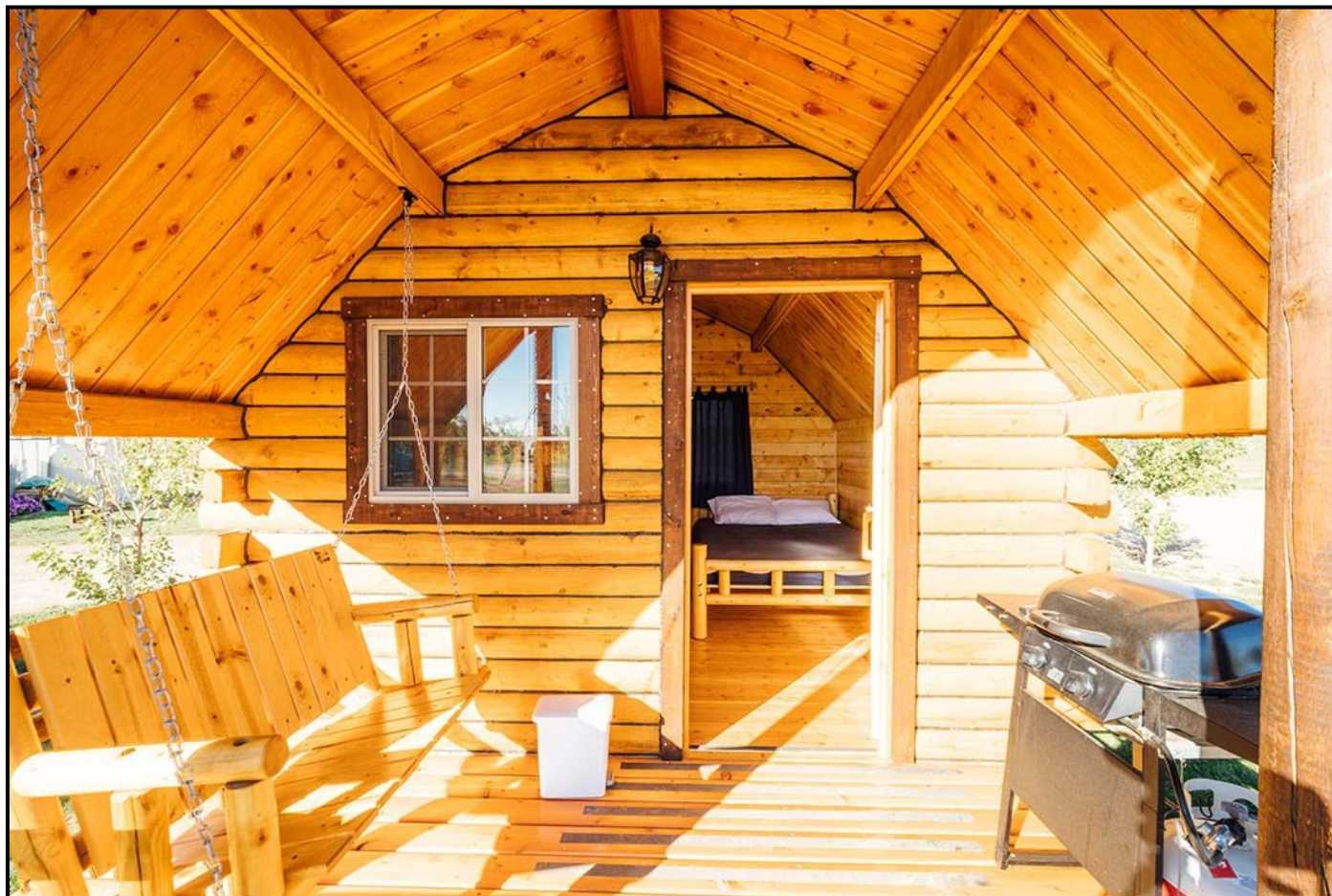

Horseshoe Canyon Campground Dumheller , AB

Our one-room cabin has a rustic feel complete with “old-time” handmade door with special wood hinges and a drawstring latch. Your camping families will make memories they will not forget! Comfortably sleeps four.

Our **One-Room Cabin** is complete with everything you need to rent the cabin.

Preassembled Cabin

\$35,800

Kit Only (Unassembled)

\$25,800

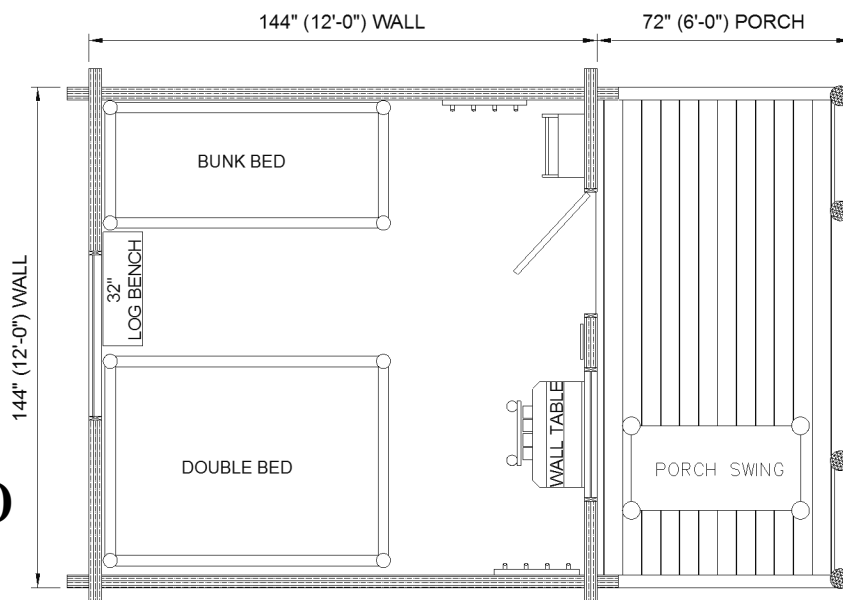

One-Room Cabin Includes:

Electric package & LED Lights & Heater
 Log Bunk bed
 Log Double bed
 5" Memory Foam Bunk Mattresses (2)
 8" Memory Foam Full Mattress
 Wall table
 Wall bench
 Wall mirror
 Wall shelf
 Log chair
 Log Porch swing
 Clothes hangers (2)

Flooring: Douglas fir, 2 x 6, tongue and groove
 Log Walls: Tongue and groove exterior side walls
 Door: Wood exterior door with deadbolt lock
 Porch: Radius Douglas Fir decking, post and rails
 Windows: Front (tempered glass) and rear for a total of 2 vinyl insulated windows
 Roof: Gambrel cedar shake (see upgrades for metal or asphalt)
 Finishes: Exterior and interior stains and varnishes along with caulking for the log walls.
 Hardware: All screws, nails, and other necessary hardware.

This cabin is sure to generate profits for your campground. Please call us to learn about the additional upgrades and accessory items we offer to enhance your new cabins!



Horseshoe Canyon Campground Dumheller , AB



Two-Room KOA Cabin

PREASSEMBLED

14' W x 16'-7" L plus 6' Porch



Preassembled Cabin

\$53,900

Kit Only (Unassembled)

\$39,900

Our **Two-Room Cabin** includes two separate sleeping rooms. Similar to the One-Room Cabin, but with a private bunk room and front room with a double bed.

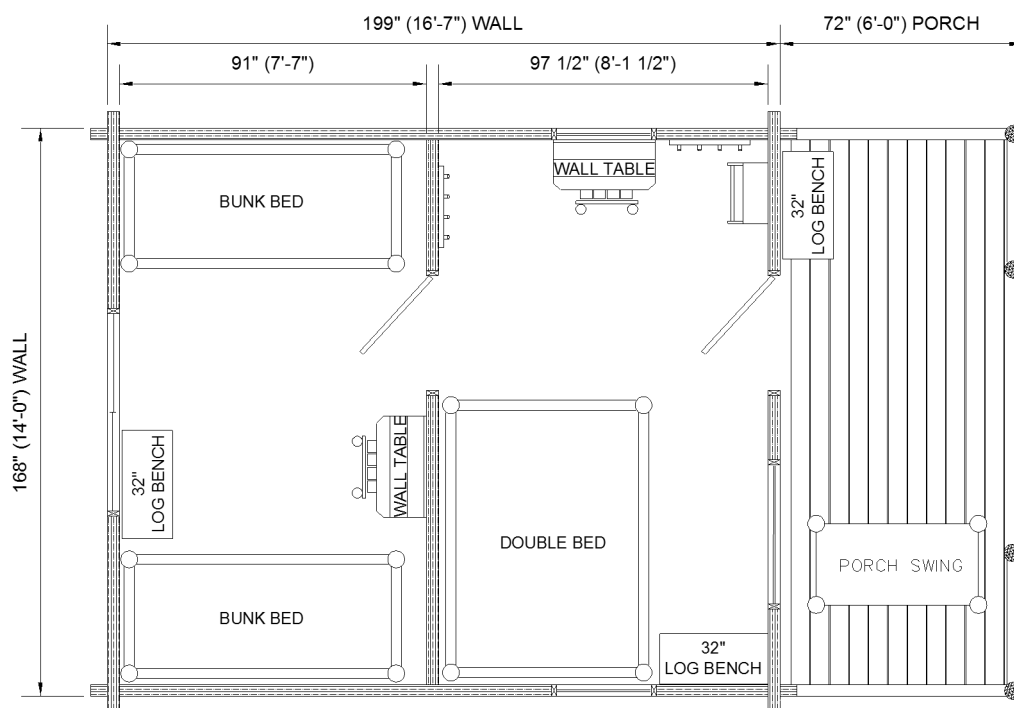

Two-Room Cabin Includes:

Electric package & LED Lights (3) & Heater	Flooring:	Douglas Fir, 2 x 6, tongue and groove
Interior wall with wood door	Log Walls:	Tongue and groove exterior side walls
Log Bunk beds (2)	Door:	Wood exterior door with deadbolt lock
Log Double bed	Porch:	Radius Douglas Fir decking, post and rails
5" Memory Foam Bunk Mattresses (4)	Windows:	Front (tempered glass) and rear for a total of 2 vinyl insulated windows
8" Memory Foam Full Mattress	Roof:	Gambrel cedar shake (see upgrades for metal or asphalt)
Wall tables (2)	Finishes:	Exterior and interior stains and varnishes along with caulking for the log walls
Wall benches (3)	Hardware:	All screws, nails, and other necessary hardware
Wall mirrors (2)		
Wall shelf		
Log chairs (2)		
Porch swing		
Clothes hangers (3)		



Two-Room Cabins can ship 2 per truckload!



Studio Cottage

PREASSEMBLED

14'-5" W x 20' L plus 6' porch



The camping experience with the added convenience of a bathroom! Perfect for campers who do not want to trek across the campground in the middle of the night or during cold winter months. This open floor plan comfortably sleeps four.

**Preassembled
Cottage**
\$98,800
**Kit Only
(Unassembled)**
\$86,000

Our Studio Cottage includes a Queen bed, Full size sleeper sofa, complete bath and dining for two.

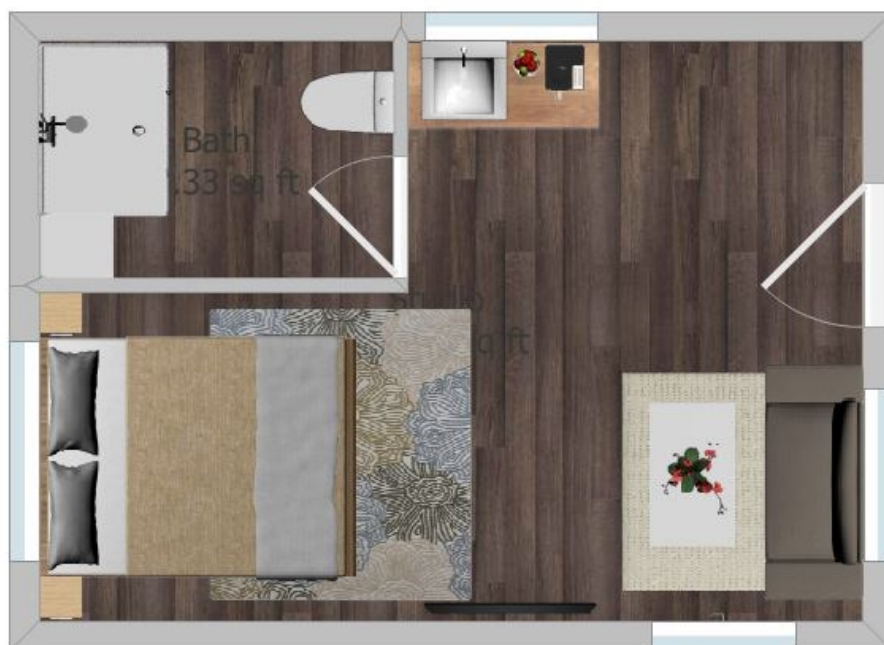

Studio Cottage Includes:

Electric package & LED Lights (3) and Heater
 Exterior Therma-Tru door
 Foundation package
 Side walls - twelve courses
 Insulation package– Roof & Floor
 Bathroom with fixtures, 4' fiberglass shower
 Additional windows (2)
 Ceiling fan
 Log Bunk bed
 Log Double bed or Futon
 5" Memory Foam Bunk Mattress (2)
 8" Memory Foam Full Mattress
 Wall bench
 Wall mirror
 Log table
 Log chairs (4)
 Porch swing

Flooring: Douglas Fir, 2 x 6, tongue and groove
 Log Walls: Tongue and groove fourteen log courses high exterior side walls (optional interior walls available)
 Door: Insulated fiberglass Therma-Tru exterior door with deadbolt and passage lock
 Porch: Radius Douglas Fir decking, post and rails
 Windows: Front (tempered glass), Rear and Side for a total of 6 vinyl insulated slider windows
 Roof: Gambrel cedar shake, (see upgrades for metal or asphalt)
 Finishes: Exterior and interior stains and varnishes along with caulking for the log walls
 Hardware: Foam sealant between the log courses (for additional insulation and weather protection) along with all screws, nails, and other necessary hardware

Studio Cottage (14'-5" x 20')



Deluxe KOA Cottage

PREASSEMBLED

14' W x 22' L plus 6' porch



Great Falls, MT KOA

The deluxe cottage offers a camping experience with all of the comforts of home! Complete with kitchen and bathroom, our cottages are perfect for occupying for a week or even a month. Comfortably sleeps 4.

Preassembled Deluxe Cottage

\$107,800

Kit Only (Unassembled)

\$97,800

The **Deluxe Cottage** comes complete with everything you need to rent the cabin. Please call us to learn about the additional upgrades and accessory items we offer to enhance your new cabins!

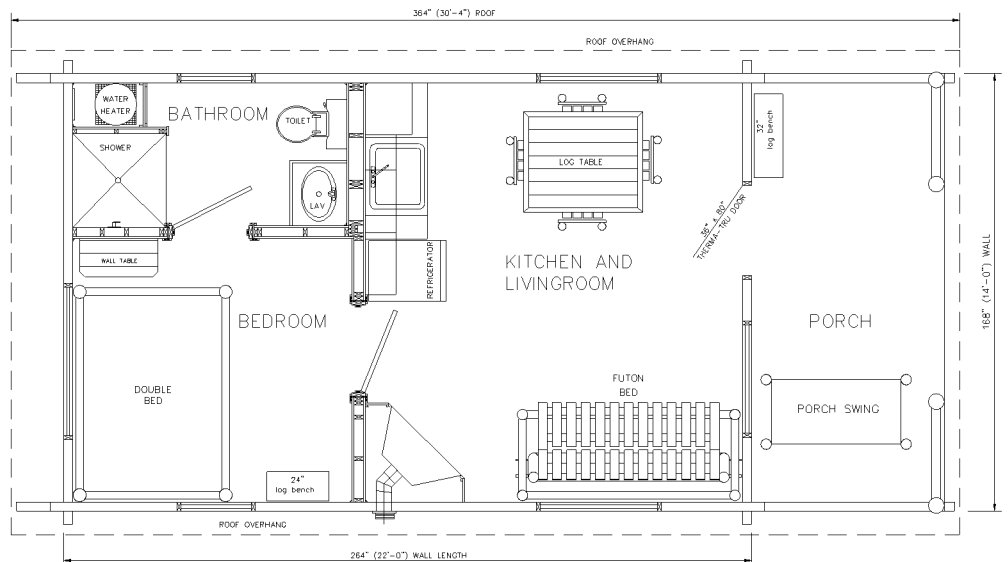

14x22 FLOOR PLAN

Deluxe Cottage Includes:

Electric package & LED Lights (3) and Heater
 Exterior Therma-Tru door
 Foundation package
 Side walls - 14 Log Courses High
 Insulation package— Roof & Floor
 Bathroom with fixtures, 4' fiberglass shower,
 wall hung toilet, sink
 Kitchen Fixtures: cabinets, counter tops, sink, stove
 (built-in cook top-two burner) or range with
 oven, microwave, refrigerator.
 Kitchen Electrical Fixtures: Under cabinet counter
 top light, stove ventilating vent piping,
 pendant lighting, etc.
 Ceiling fan
 Log Bunk bed, Double or Queen bed
 Log Double bed or Futon
 5" Memory Foam Bunk Mattress (2)
 8" Memory Foam Full Mattress
 Wall bench
 Wall mirror
 Log table
 Log chairs (4)
 Porch swing

Flooring: Douglas Fir, 2 x 6, tongue and
 groove
 Log Walls: Tongue and groove fourteen log
 courses high exterior side walls
 (optional interior walls availa-
 ble)
 Door: Insulated fiberglass Thermal
 True exterior door with deadbolt
 and passage lock
 Porch: Radius Douglas Fir decking, post
 and rails
 Windows: Front (tempered glass), Rear and
 Side for a total of 6 vinyl
 insulated slider windows
 Roof: Gambrel cedar shake, (see
 upgrades for metal or asphalt)
 Finishes: Exterior and interior stains and
 varnishes along with caulking for
 the log walls
 Hardware: Foam sealant between the log
 courses (for additional insulation
 and weather protection) along
 with all screws, nails, and other
 necessary hardware

****LOFTS ARE NOT AVAILABLE ON PREASSEMBLED COTTAGES DUE
 TO HEIGHT RESTRICTIONS DURING SHIPPING.**



Double Deluxe KOA Cottage

PREASSEMBLED

14' 6" W x 26' L plus 6' porch



The double deluxe cottage is packed with amenities for a luxury camping experience. Perfect for a family adventure, this cottage has a separate master bedroom and bunk room with beautiful barn doors for privacy. A full bathroom and kitchen with complete suite of stainless steel appliances give this cottage every amenity needed for a getaway! Comfortably sleeps six.

Preassembled Double Deluxe Cottage

\$118,900

Kit Only (Unassembled)

\$99,800

The **Double Deluxe Cottage** comes complete with everything you need to rent the cabin. Please call us to learn about the additional upgrades and accessory items we offer to enhance your new accommodations!



Double Deluxe Cottage Includes:

Electric package & LED Lights (3) and Heater
Exterior Thermo-Tru door

Foundation package—Pressure Treated Skids

Side walls - 14 Log Courses High

Insulation package— Roof & Floor

Bathroom with fixtures, 4' fiberglass shower,
wall hung toilet, sink

Kitchen Fixtures: cabinets, counter tops, sink, stainless
steel appliances.

Kitchen Electrical Fixtures: Under cabinet counter
top light, stove ventilating vent piping,
pendant lighting, etc.

Log Bunk bed

Log Queen bed

Sofa bed or Futon

5" Memory Foam Bunk Mattress (2)

12" Memory Foam Queen Mattress

Wall bench

Wall mirror

Log table and half log breakfast bar

Log chairs (6) or benches

Porch swing

Porch bench

Flooring: Douglas Fir, 2 x 6, tongue and
groove

Log Walls: Tongue and groove fourteen log
courses high exterior side walls
(optional interior walls availa-
ble)

Door: Insulated fiberglass Thermo -Tru
exterior door with deadbolt and
passage lock

Porch: Radius Douglas Fir decking,
posts and rails

Windows: Front (tempered glass), Rear and
Side for a total of 7 vinyl
insulated slider windows.

Roof: Gambrel cedar shake, (see
upgrades for metal or asphalt).

Finishes: Exterior and interior stains and
varnishes along with caulking for
the log walls.

Hardware: Foam sealant between the log
courses (for additional insulation
and weather protection) along
with all screws, nails, and other
necessary hardware.



NEW FLOOR PLAN

Prairie Kraft Specialties, LLC

1500 51st Street South, Great Falls, MT 59405

Phone: (406) 727-3192 Fax: (406) 727-3239

E-mail: sales@pkscabins.com

www.pkscabins.com

